

Monologue or dialogue

– the design of industrial building envelopes made of metal sheet



Architektur + Metallbau
Prof. Dr. Helmut Hachul

Fachhochschule
Dortmund
University of Applied Sciences and Arts



Monologue or dialogue

– the design of industrial building envelopes made of metal sheet

- Introduction
- Lightweight façade systems
- Design of metal sheet envelopes
- Energetic façades

Monologue or dialogue

– the design of industrial building envelopes made of metal sheet

Introduction



Monologue or dialogue

– the design of industrial building envelopes made of metal sheet

„Tension triangle“ of design

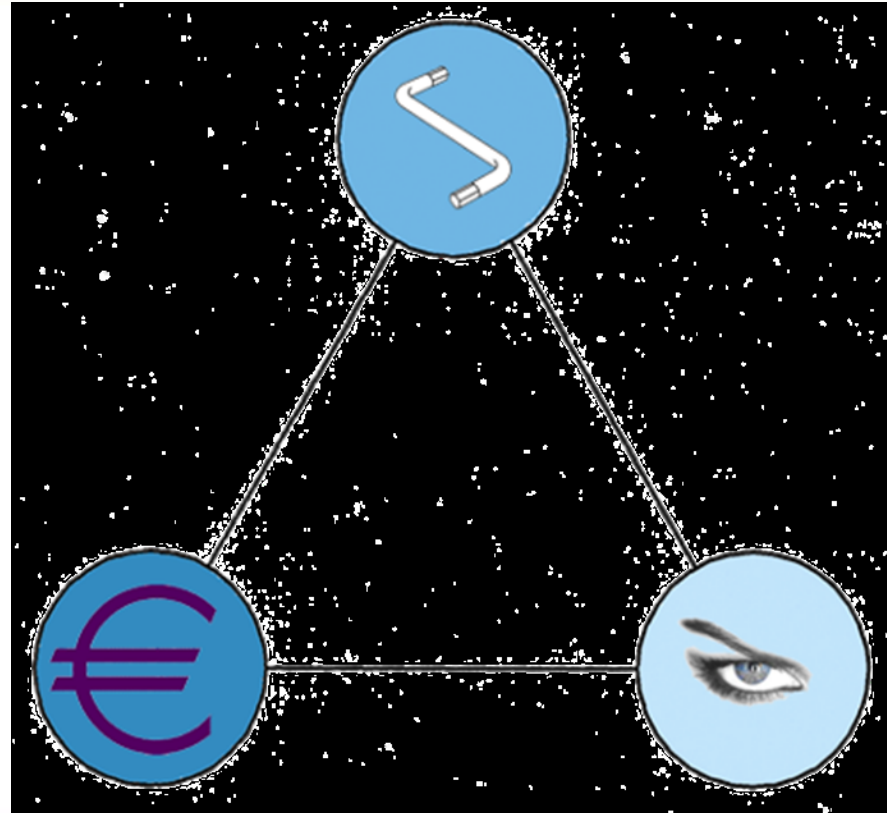

Monologue or dialogue

– the design of industrial building envelopes made of metal sheet

Design – what for...?

Typical application area of metal sheet systems

Business park on outskirts of town
(Hagen)



Monologue or dialogue

– the design of industrial building envelopes made of metal sheet

Design – what for...?

Economically, efficiently - and allegedly with silver the solution for building envelopes in the industrial and commercial (Wuppertal)



Monologue or dialogue

– the design of industrial building envelopes made of metal sheet

Design – what for...?

Even round shapes can be realized, -
but where has the spirit of dynamic
gone? (Kerpen)



Monologue or dialogue

– the design of industrial building envelopes made of metal sheet

Design – what for...?

Advertising is everything!

Corporate Identity in the façade design of a discount store, again Kerpen.
White as the perfect background.



Monologue or dialogue

– the design of industrial building envelopes made of metal sheet

Design – what for...?

A 20 meter metal sheet façade in an urban situation.

Green means hope!, Maybe the hope, the wall will disappear somewhen...



Monologue or dialogue

– the design of industrial building envelopes made of metal sheet

Design... a matter of capability and responsibility!

Large warehouse, large volume.

Trapezoidal wall profile and steel cassette panels are ideal construction elements for industrial façades.



Monologue or dialogue

– the design of industrial building envelopes made of metal sheet

Scale and volume...

„Familiar environment“ for building planners:

1-2 stories

5-6 meters wide



Monologue or dialogue

– the design of industrial building envelopes made of metal sheet

Scale and volume...

Small warehouse:

Height: 6m

Lengths: 50m



Monologue or dialogue

– the design of industrial building envelopes made of metal sheet

Scale and volume...

Industrial buildings, power plants, etc.

Often 50meters high and up to 500 meters long



Monologue or dialogue

– the design of industrial building envelopes made of metal sheet

Scale and volume...

How long walks the green man?

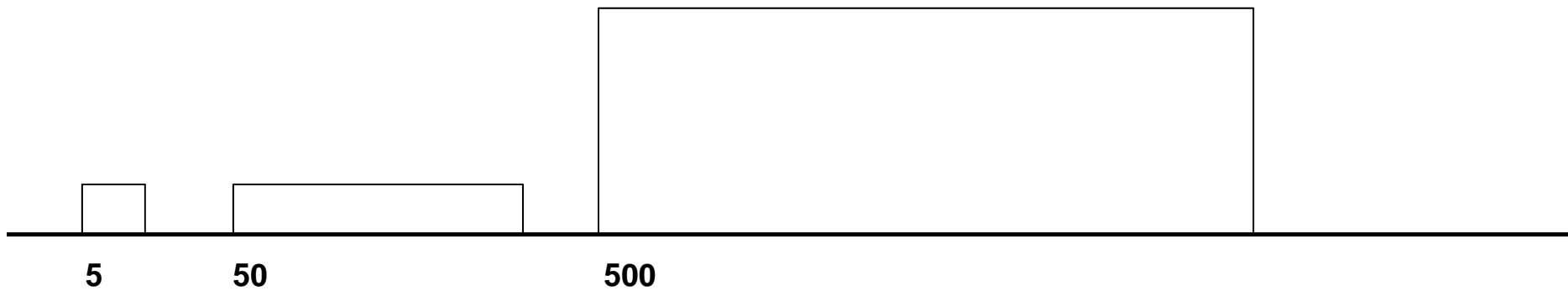

Monologue or dialogue

– the design of industrial building envelopes made of metal sheet

Façade arrangement

- Restricted profiling...
- Restricted ornamentation...
- Restricted game with openings...
- No „classic“ floors...



Monologue or dialogue

– the design of industrial building envelopes made of metal sheet

Is this the end... ?



Monologue or dialogue

– the design of industrial building envelopes made of metal sheet

Lightweight façade systems

Monologue or dialogue

– the design of industrial building envelopes made of metal sheet

Advantages:

- Synergy of load bearing and weather protection
- Minimizing secondary construction
- Low weight
- Great length
- Quick fitting
- Low tolerances
- Reliable construction systems
- Ideal protection against corrosion

Monologue or dialogue

– the design of industrial building envelopes made of metal sheet

Overview:

- Corrugated iron
- Trapezoidal profiles
- Steel cassetts
- Sandwich elements
- Coffered systems
- Panels
- Custom-made products

Monologue or dialogue

– the design of industrial building envelopes made of metal sheet

Corrugated iron

Origin of the metal sheet
construction systems

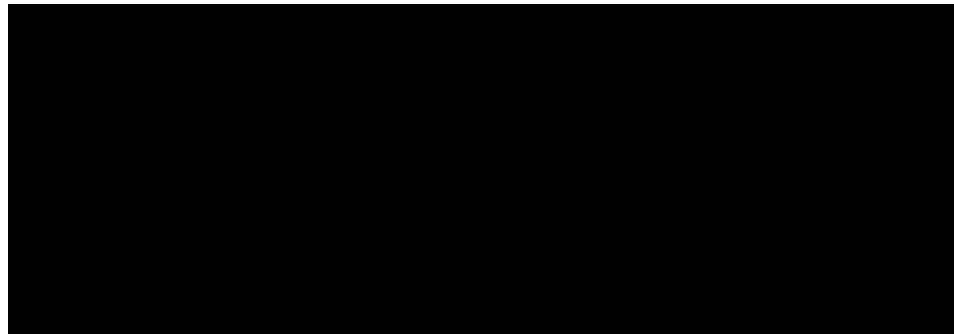
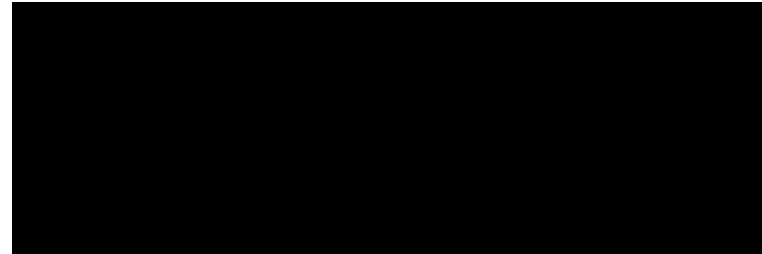
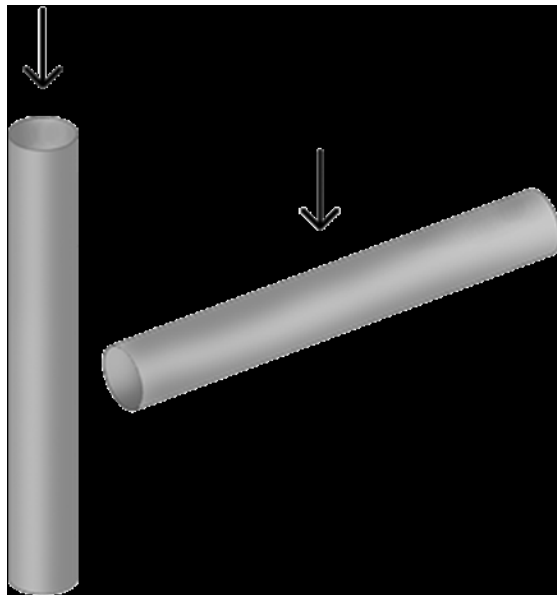

Monologue or dialogue

– the design of industrial building envelopes made of metal sheet

Corrugated iron

Outer shell of steel cassette systems or sandwich elements

Horizontal und vertical application possible

Separation profiles bridge joints

80-106cm wide

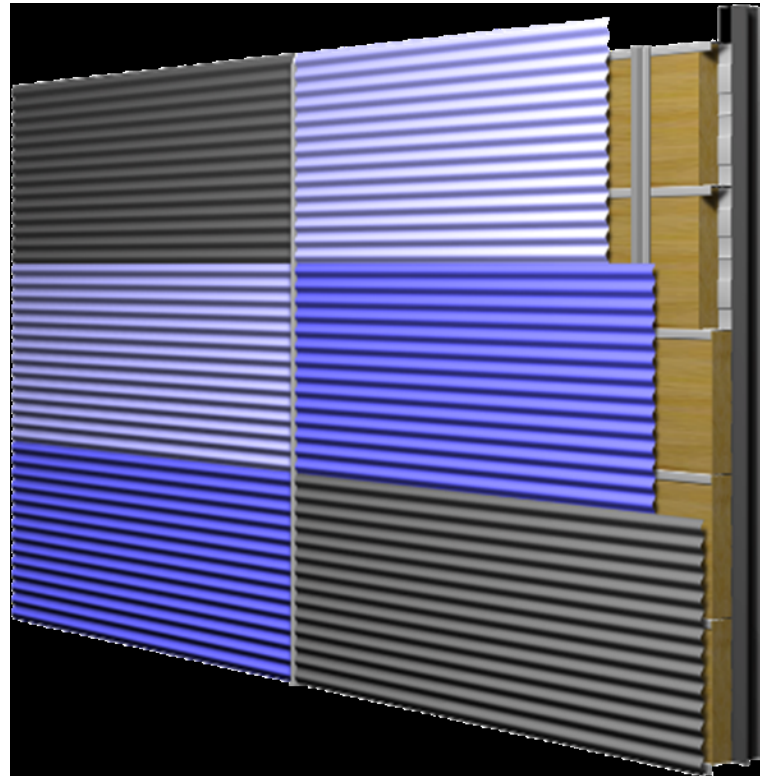

Monologue or dialogue

– the design of industrial building envelopes made of metal sheet

Corrugated iron

Continuous waveform produces smooth transition between the upper and lower chords.

Light and shadow areas are approximately equal.

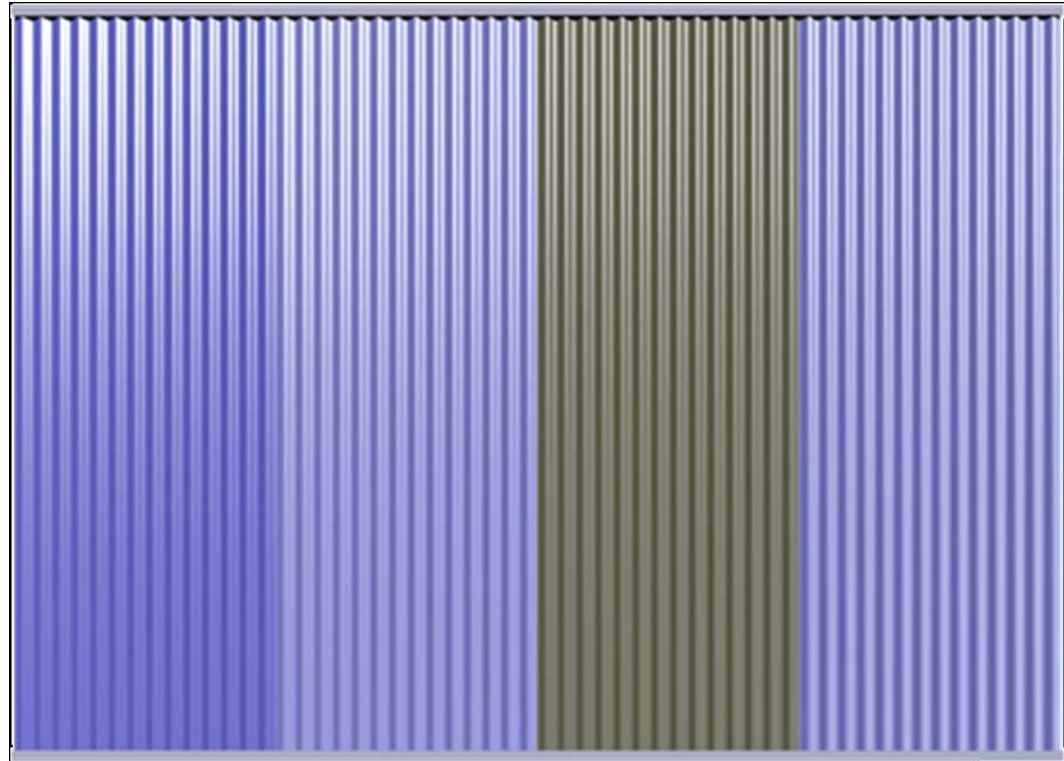

Monologue or dialogue

– the design of industrial building envelopes made of metal sheet

Trapezoidal profiles

Static coherent development of
the wave profiles

Span up to 10 meter

Wide approx. 75-107 cm

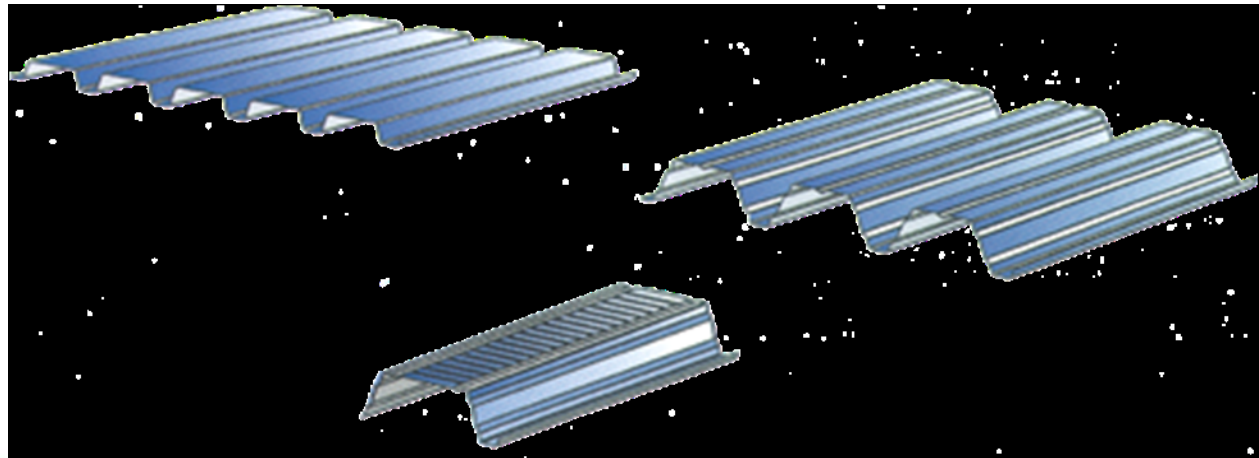

Monologue or dialogue

– the design of industrial building envelopes made of metal sheet

Trapezoidal profiles

Outer shell of steel cassette system or sandwich elements

Positiv- and negativ positions possible

Horizontal und vertical application possible

Wide approx. 75-107 cm

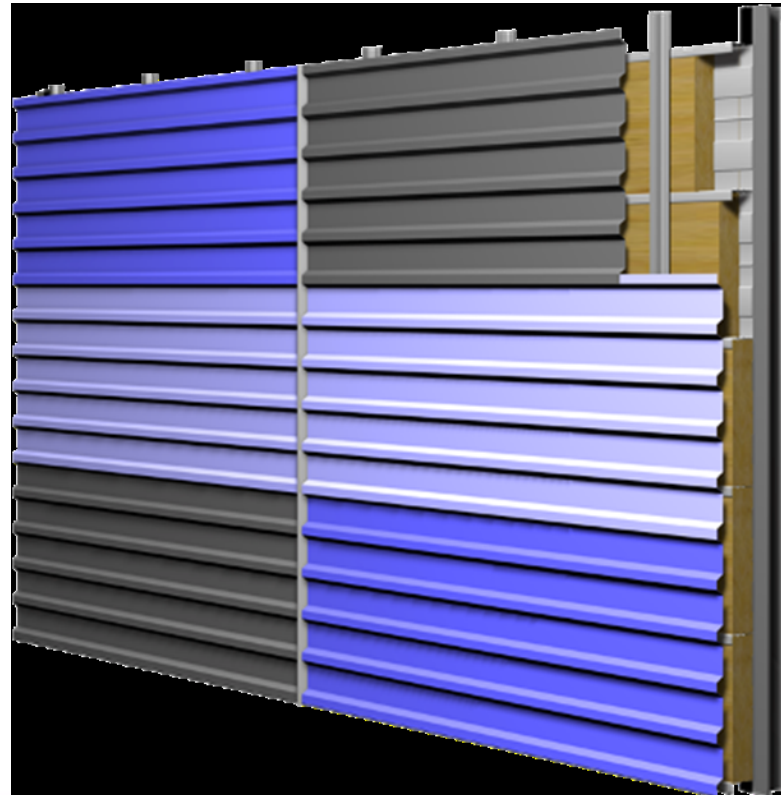

Monologue or dialogue

– the design of industrial building envelopes made of metal sheet

Trapezoidal profiles

Classic use:

Positive position in vertical
direction

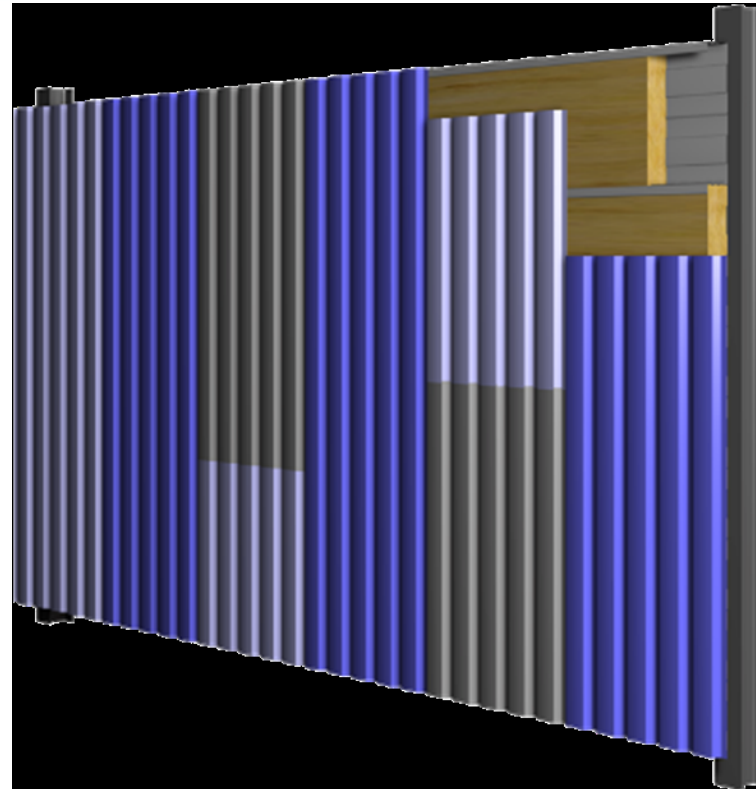

Monologue or dialogue

– the design of industrial building envelopes made of metal sheet

Trapezoidal profiles

Horizontal views. In negative position shaded areas can be larger.

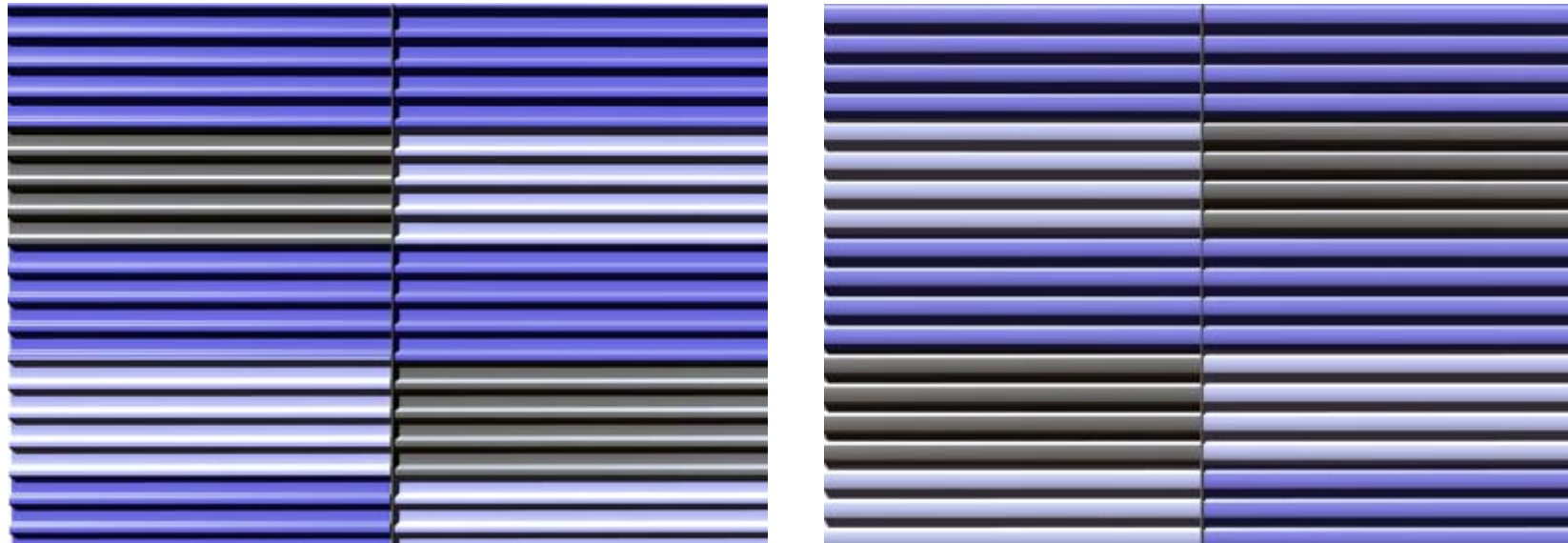

Monologue or dialogue

– the design of industrial building envelopes made of metal sheet

Steel cassetts

Load bearing structure for vertical and horizontal loads

Insulation must be positioned over the carving



Quelle: Deutsche Rockwool / SFS intec

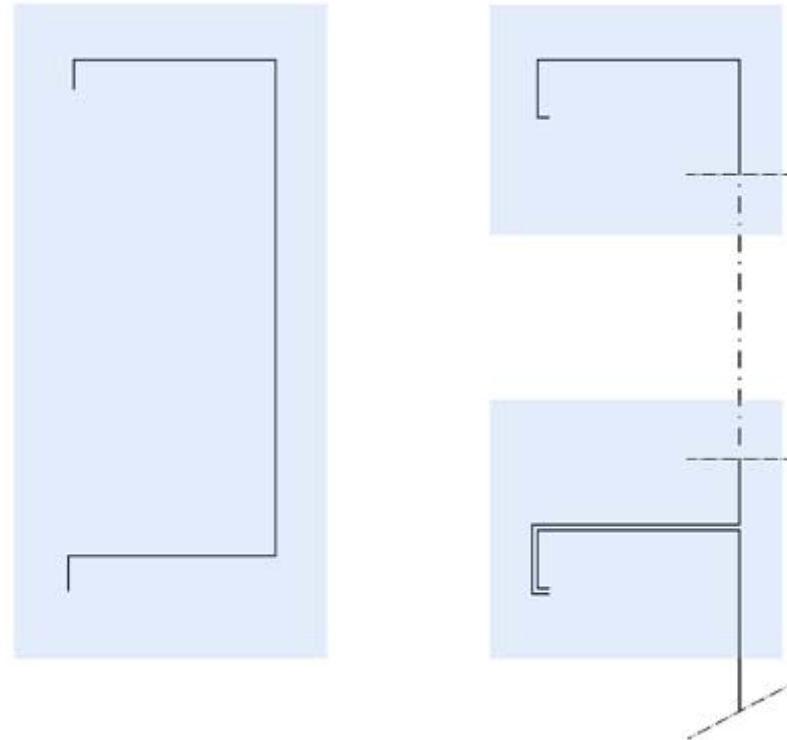

Monologue or dialogue

– the design of industrial building envelopes made of metal sheet

Steel cassetts

Design idea: interior is a façade too!

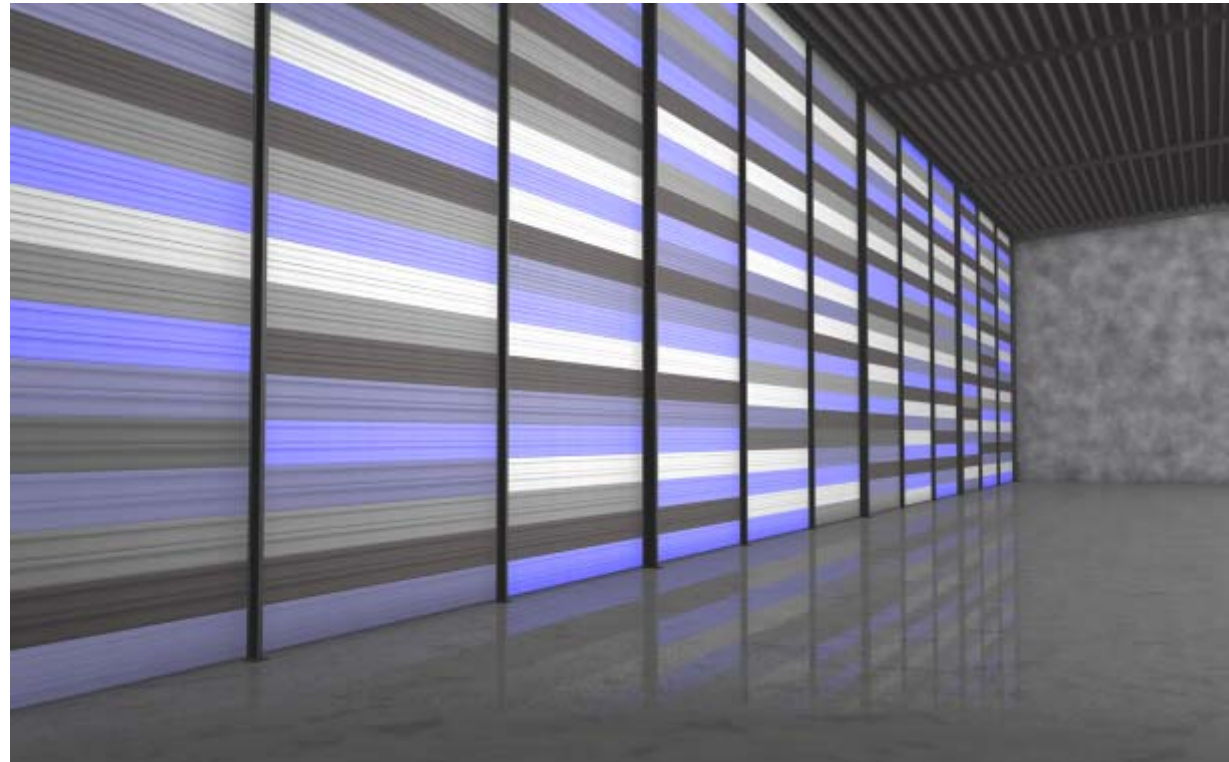

Monologue or dialogue

– the design of industrial building envelopes made of metal sheet

Sandwich elements

Insulates (PU-Foam, mineral wool) and bears loads in one element

Load capacity is generated by internal lever arm

Cover sheets are weather skin and serve the load transfer

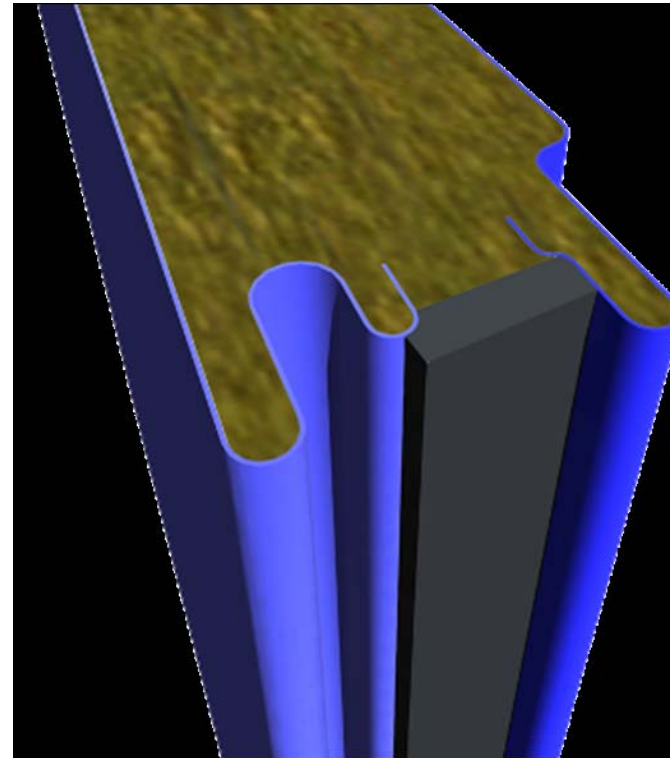

Monologue or dialogue

– the design of industrial building envelopes made of metal sheet

Sandwich elements

Outer cover sheet may be profiled or just plan

Horizontal and vertical installation possible

Cover strip over transverse joints in the horizontal position (no tongue and groove system)

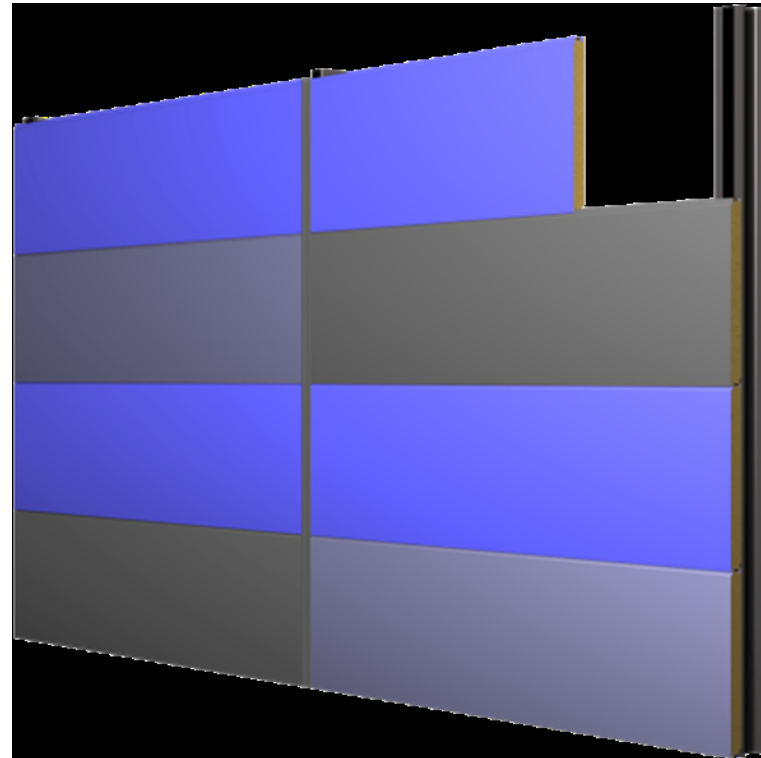

Monologue or dialogue

– the design of industrial building envelopes made of metal sheet

Coffered systems

Small-piece construction system

Joint disposition and variable arrangement possible

Subconstruction necessary

Insulated and uninsulated systems

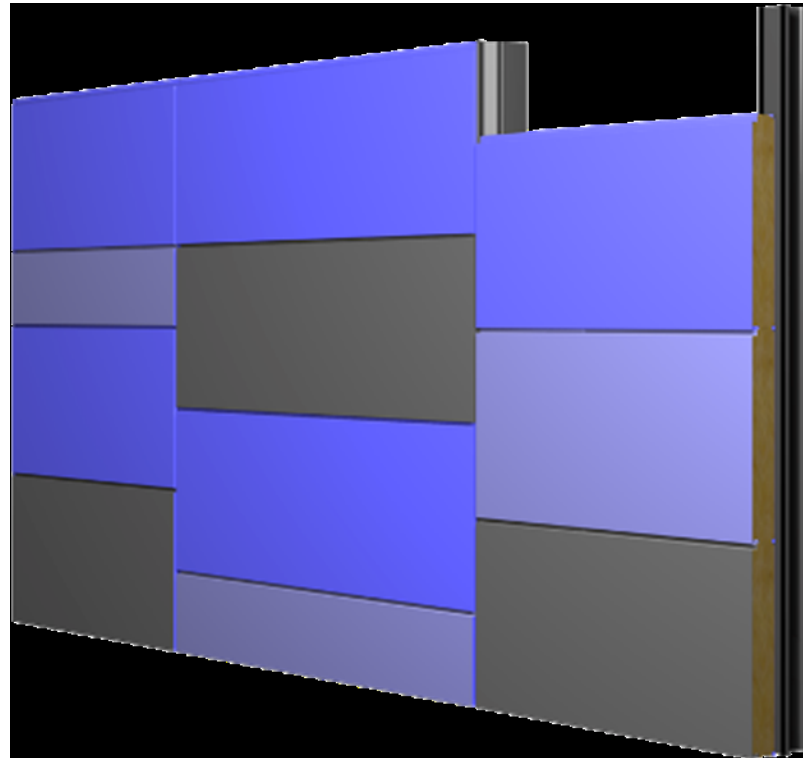

Monologue or dialogue

– the design of industrial building envelopes made of metal sheet

Paneels

Outer shell on steel cassetts

Manufactured by rollforming

Different profiles and widths possible
(approx. 20-40 cm)

Horizontal und vertikal orientantion possible

Finer lining of the envelope

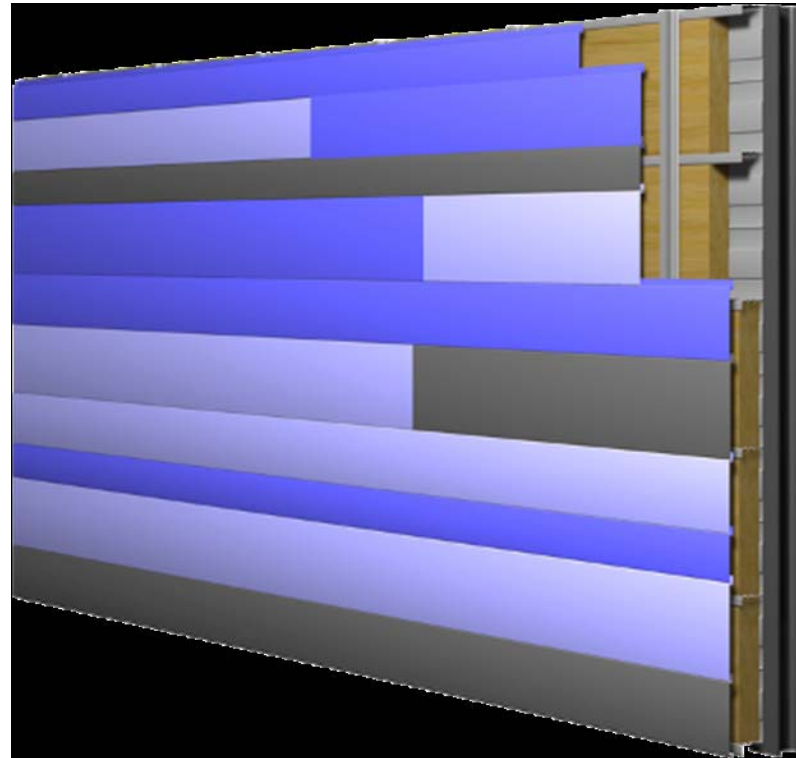

Monologue or dialogue

– the design of industrial building envelopes made of metal sheet

Panels

Views of the profiles, the combination of different heights in rows or columns is possible.

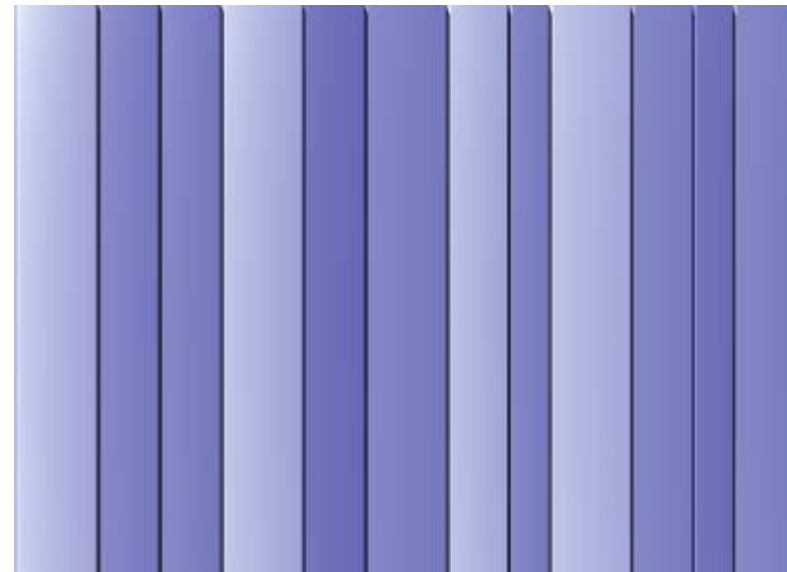
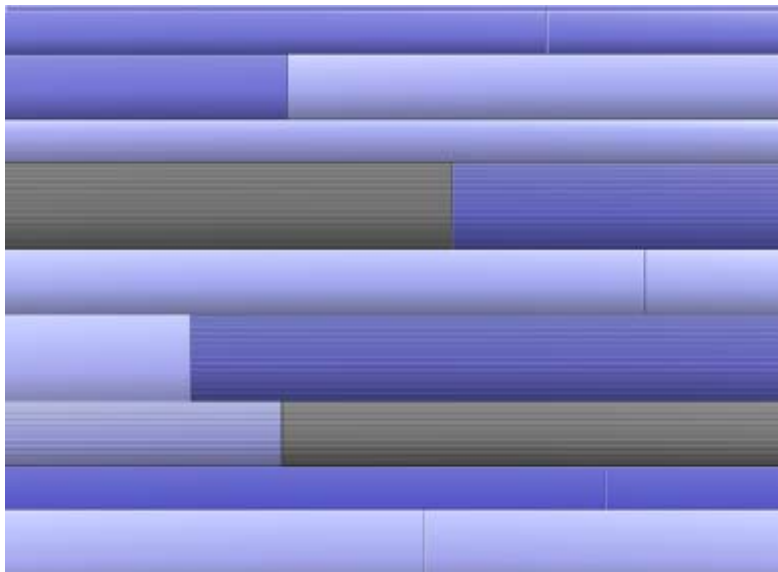

Monologue or dialogue

– the design of industrial building envelopes made of metal sheet

Custom-made products

Individual geometries can be formed in

Individual production by stamping press (limitation 6 meters)

For larger capacities rollforming is a better opportunity

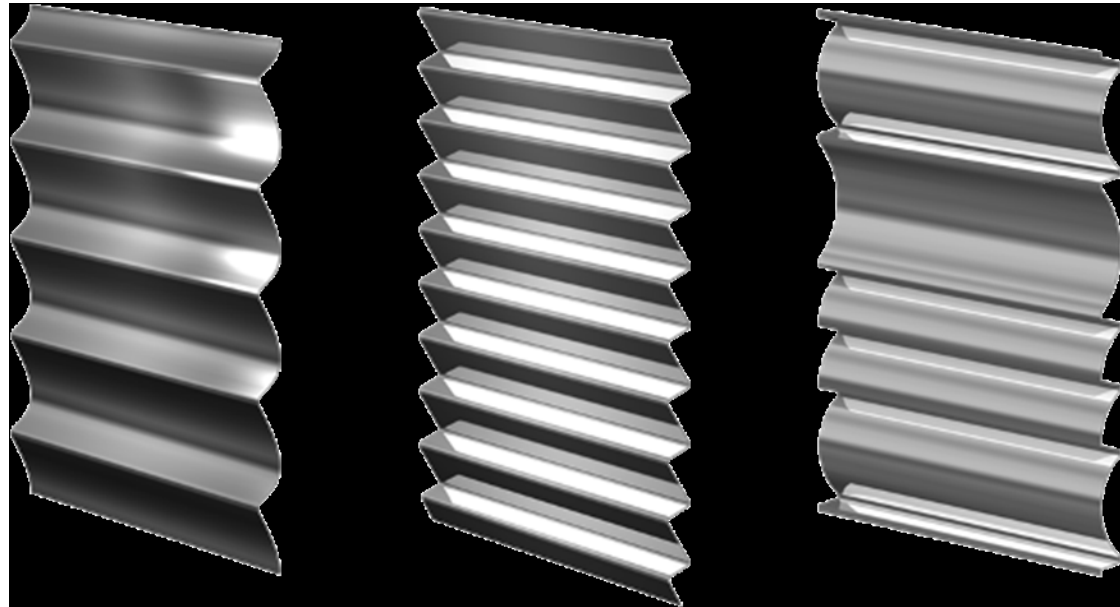

Monologue or dialogue

– the design of industrial building envelopes made of metal sheet

The design of sheet metal envelopes

Monologue or dialogue

– the design of industrial building envelopes made of metal sheet

What is the colour of
steel?

Monologue or dialogue

– the design of industrial building envelopes made of metal sheet

What is the colour of steel?

Iron ore: Chemical connection of iron, oxygen and other additions.
Iron content from 30-70%

The affinity to oxygen is cause of rust

Colour: a tendency to brown...



Monologue or dialogue

– the design of industrial building envelopes made of metal sheet

What is the colour of steel?

Galvanized coils , a variety in strenght, thickness and wide

Galvanization (zn) is appllied individually and part of the complex corrosive system

Colour: a tendency to light grey

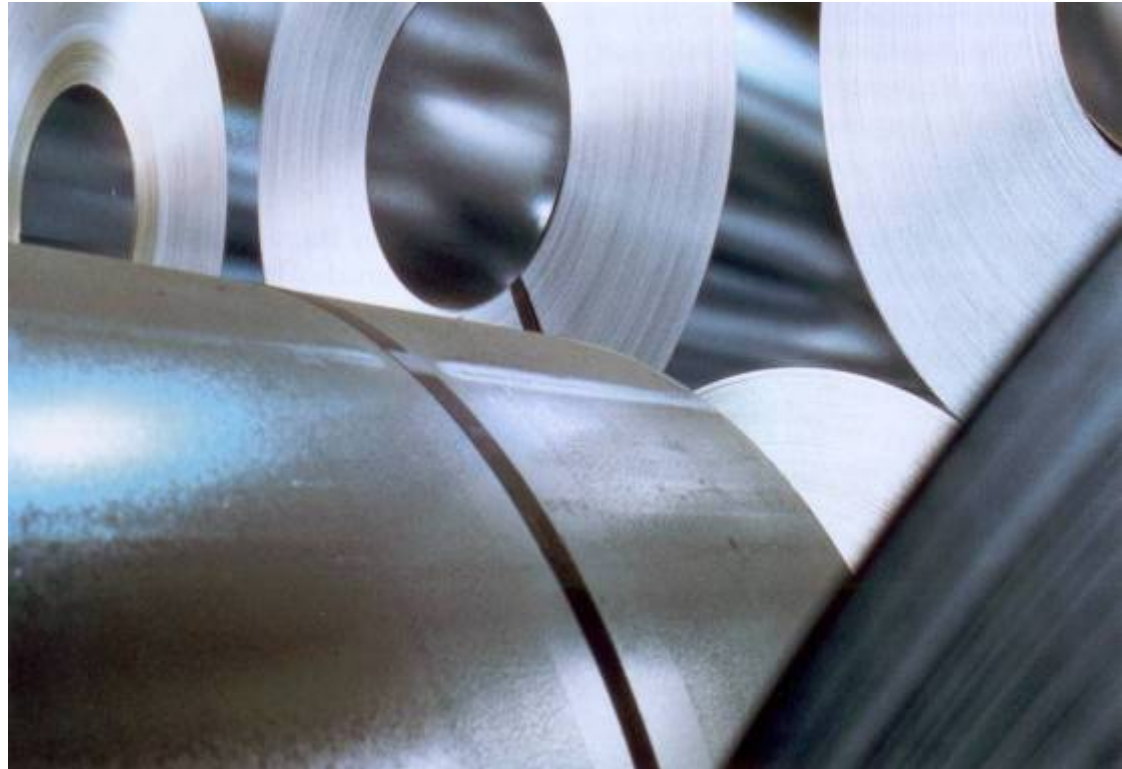

Monologue or dialogue

– the design of industrial building envelopes made of metal sheet

What is the colour of steel?

Roll-painting plant:
an economical solution for color
coating and improve corrosion
protection

Both sides can be painted different

Colour: any colour you want (even
black)



Monologue or dialogue

– the design of industrial building envelopes made of metal sheet

Coulourdome, Aachen 2002

Outside: assembly instruction –
one colour ,one part



Monologue or dialogue

– the design of industrial building envelopes made of metal sheet

Coulourdome, Aachen 2002

Inside: neutral / crystalline – one colour, silver

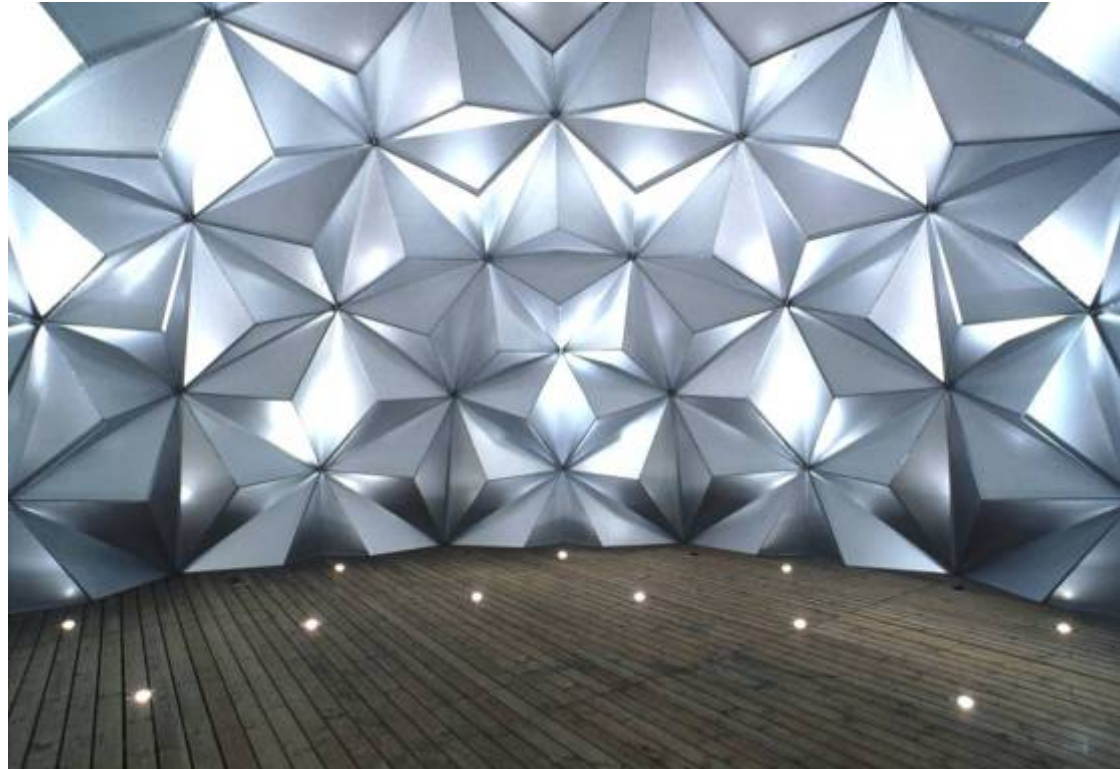

Monologue or dialogue

– the design of industrial building envelopes made of metal sheet

Monochrome
Polychrome

Volkswerft Stralsund:
300 x 108 x 75 meters.
An monochrome envelope whould have
been the economical solution



Monologue or dialogue

– the design of industrial building envelopes made of metal sheet

Monochrome
Polychrome

Realiced envelope after design of
Friedrich Ernst v. Garnier.

Differentiated and lighter in color -
Polychrome



Monologue or dialogue

– the design of industrial building envelopes made of metal sheet

Colour work

Thesis:

Colour scenes from the striking image can also be transferred to another context.

The picture goes, the mood of the picture remains.



Monologue or dialogue

– the design of industrial building envelopes made of metal sheet

Colour work

Design: M. Smyk



Monologue or dialogue

– the design of industrial building envelopes made of metal sheet

Colour work

Design: B. Mense (image template: Eduardo Chillida)



Monologue or dialogue

– the design of industrial building envelopes made of metal sheet

Colour work

Design: S. Auer



Monologue or dialogue

– the design of industrial building envelopes made of metal sheet

Colour work

Design: B. Schlösser



Monologue or dialogue

– the design of industrial building envelopes made of metal sheet

Colour work

Design: K. Moehring



Monologue or dialogue

– the design of industrial building envelopes made of metal sheet

Colour work

Design: J. Heininger (image template: Edward Hopper)



Monologue or dialogue

– the design of industrial building envelopes made of metal sheet

Colour work

Starting an exercise with the help of PC: Is an increasing of quality possible?



Monologue or dialogue

– the design of industrial building envelopes made of metal sheet

Silver/grey horizontal elements



Monologue or dialogue

– the design of industrial building envelopes made of metal sheet

Vertical trapezoidal profiles in positive position



Monologue or dialogue

– the design of industrial building envelopes made of metal sheet

Vertical sandwich elements, monochrome



Monologue or dialogue

– the design of industrial building envelopes made of metal sheet

Coloured trapezoidal profiles (expensive)



Monologue or dialogue

– the design of industrial building envelopes made of metal sheet

Coloured trapezoidal profiles (expensive)



Monologue or dialogue

– the design of industrial building envelopes made of metal sheet

Coloured trapezoidal profiles (expensive)



Monologue or dialogue

– the design of industrial building envelopes made of metal sheet

Small part covered systems in grey and green



Monologue or dialogue

– the design of industrial building envelopes made of metal sheet

Finer division by horizontal panels



Monologue or dialogue

– the design of industrial building envelopes made of metal sheet

Panels vertical

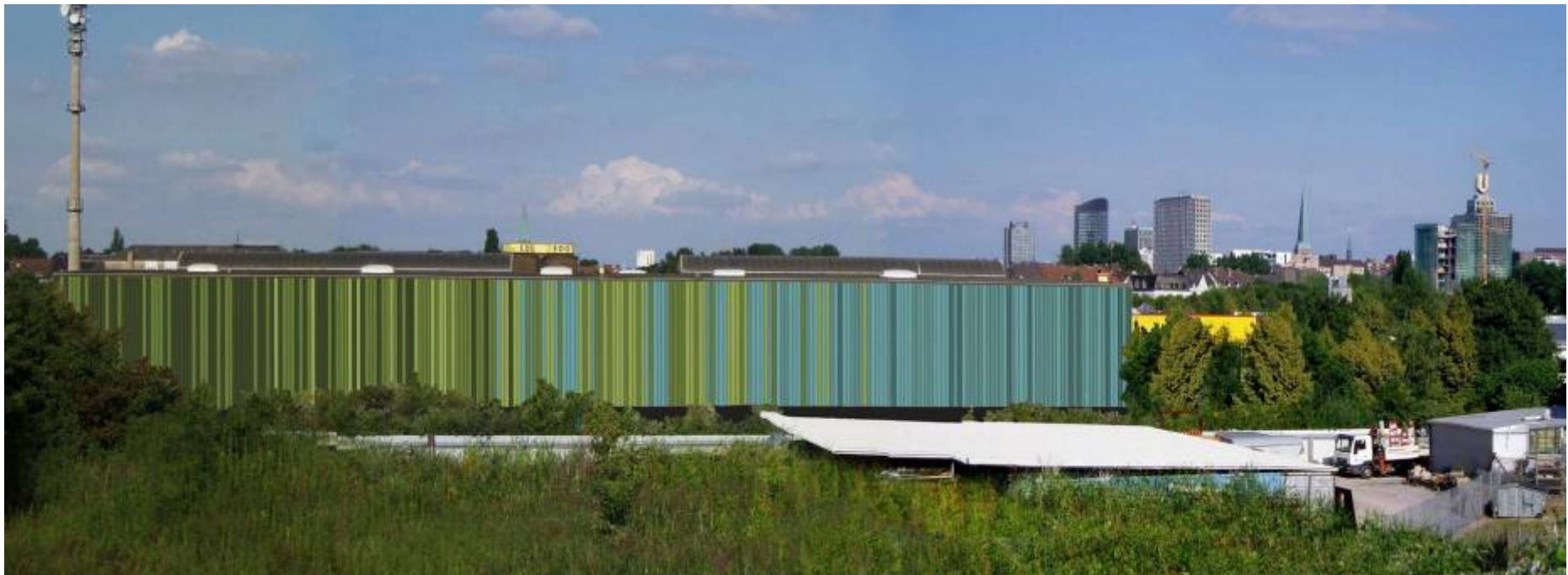

Monologue or dialogue

– the design of industrial building envelopes made of metal sheet

Sandwich elements, vertikal

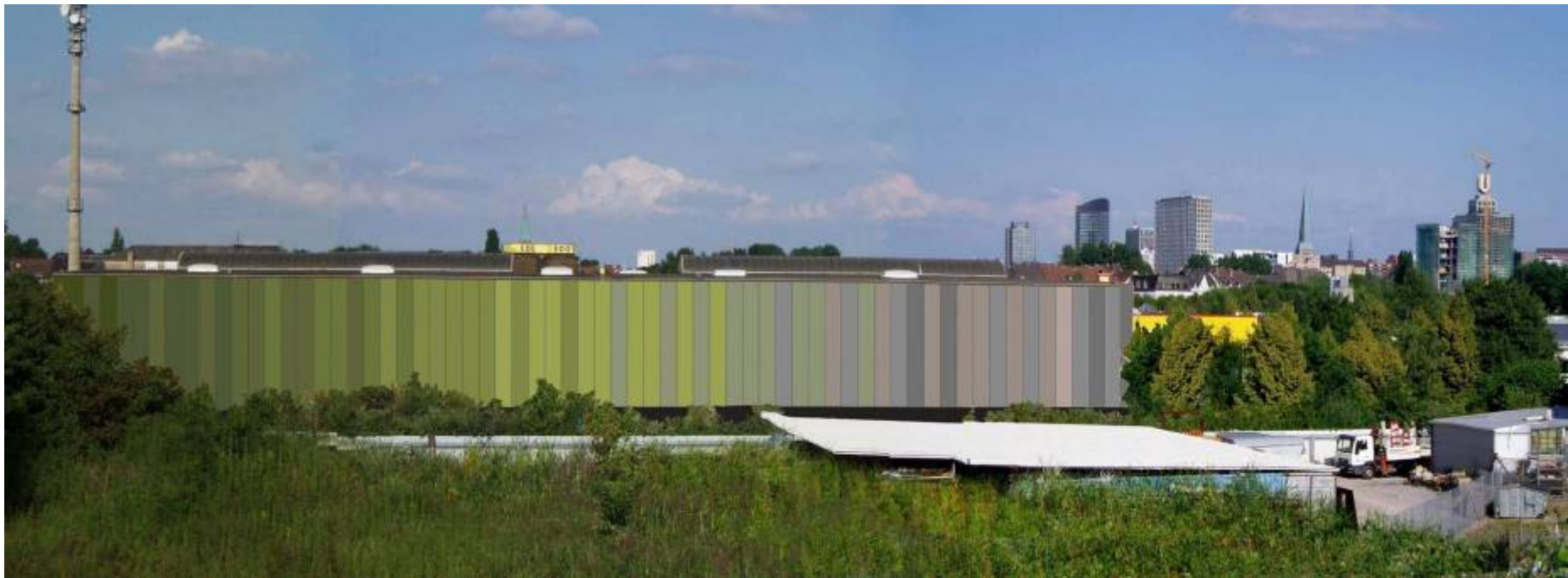

Monologue or dialogue

– the design of industrial building envelopes made of metal sheet

Individual formed stainless steel metal sheets, acting as a reflector (expensive)



Monologue or dialogue

– the design of industrial building envelopes made of metal sheet

Horizontal and vertical

One cube, two directions of structural positioning

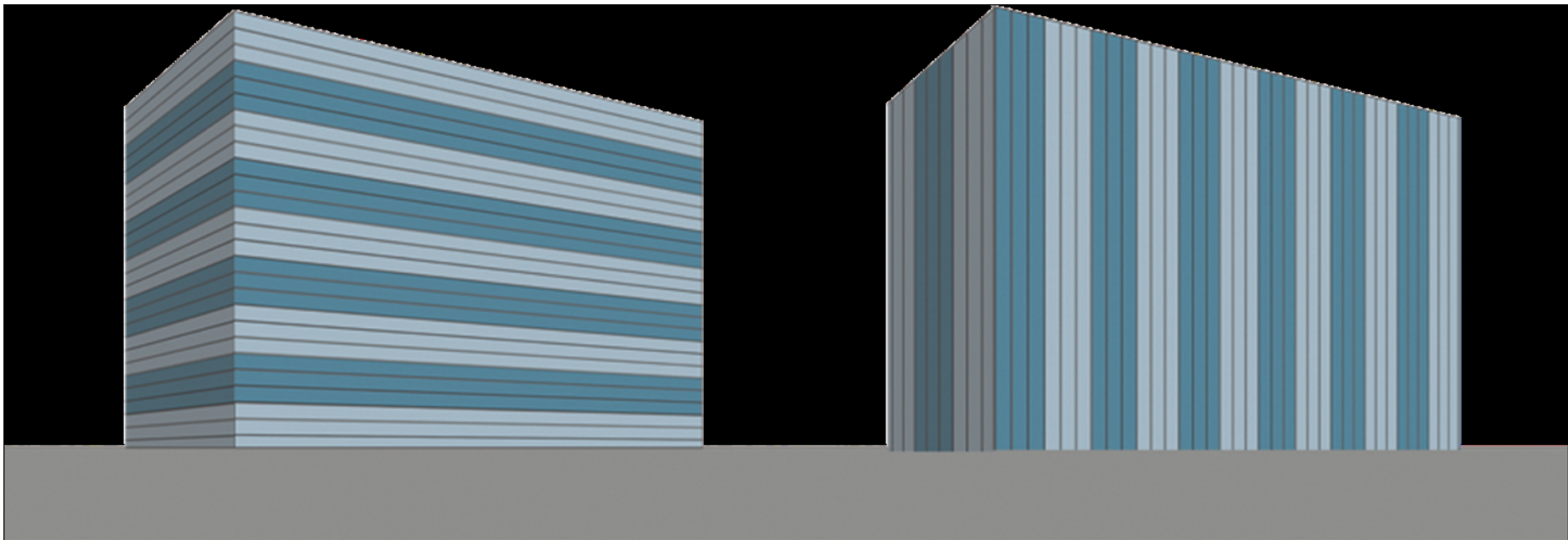

Monologue or dialogue

– the design of industrial building envelopes made of metal sheet

Horizontal and vertical

One cube, two directions of structural positioning

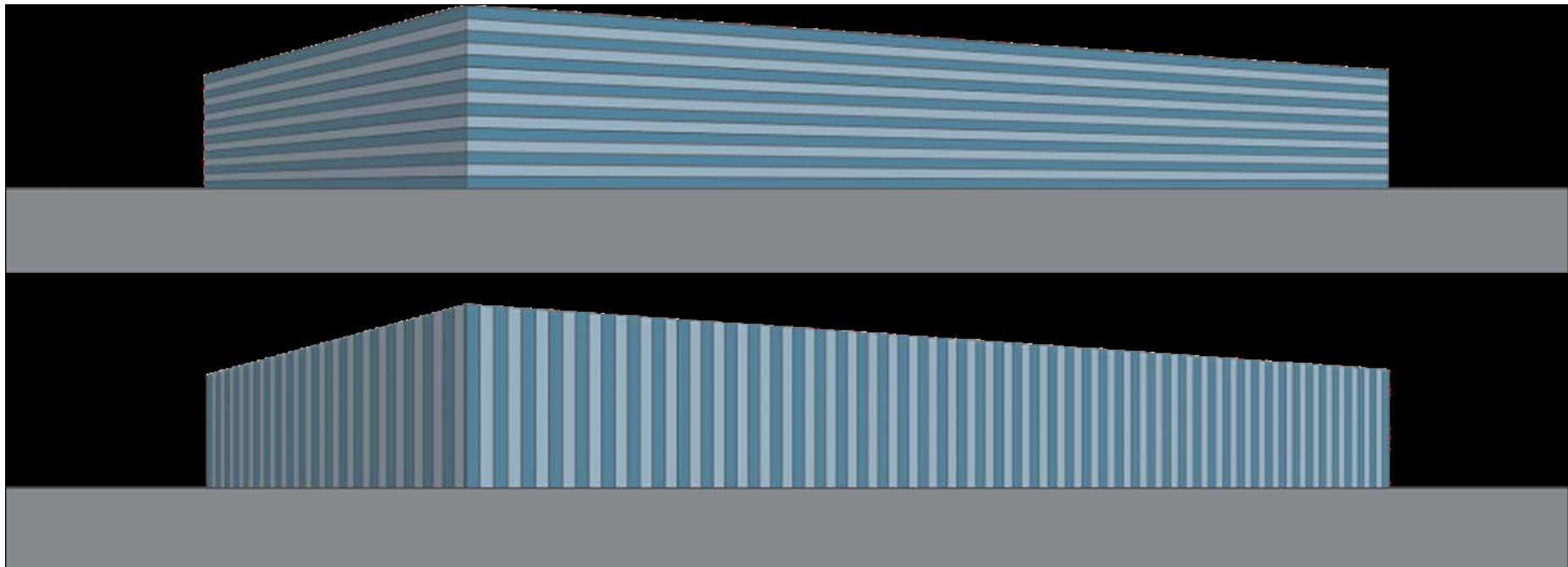

Monologue or dialogue

– the design of industrial building envelopes made of metal sheet

Coins & patterns

Optical smothering and protection against bulging– coins stabilize the metal sheet.
Patterns offer a greater visual deepness.



Monologue or dialogue

– the design of industrial building envelopes made of metal sheet

Coins & patterns

A good example for visual differentiation:

Corrugated iron with applied zinc-pattern.

Different tonation and shadows against monochrome boredom

(Ville Verdi, Vienna)



Monologue or dialogue

– the design of industrial building envelopes made of metal sheet

Foreground and background



Monologue or dialogue

– the design of industrial building envelopes made of metal sheet

Foreground and background



Monologue or dialogue

– the design of industrial building envelopes made of metal sheet

Energetic façades

Monologue or dialogue

– the design of industrial building envelopes made of metal sheet

Roof

Photovoltaic as additive (left) or integrated system (right) .

The roof provides extra energy as a bonus.



Monologue or dialogue

– the design of industrial building envelopes made of metal sheet

Façade

Also on the facade of the application of PV elements is possible. Variations do not affect the energy input.



Monologue or dialogue

– the design of industrial building envelopes made of metal sheet

Solarthermal activation for building tempering: energy profit with industrial building envelopes. Target is system-integration (in combination with PV).

AIF-Project: Prof. Dr. Hachul CO Prof. Rogall

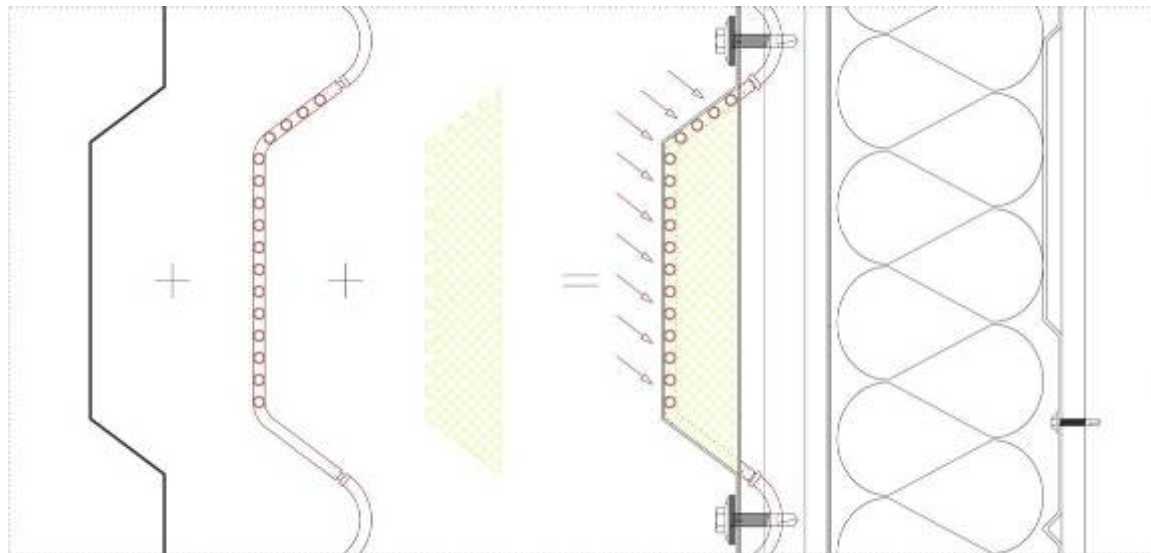

Monologue or dialogue

– the design of industrial building envelopes made of metal sheet

Solarthermal activation for building tempering: energy profit with industrial building envelopes. Target is system-integration (in combination with PV).

AIF-Project : Prof. Dr. Hachul CO Prof. Dr. Ummenhofer

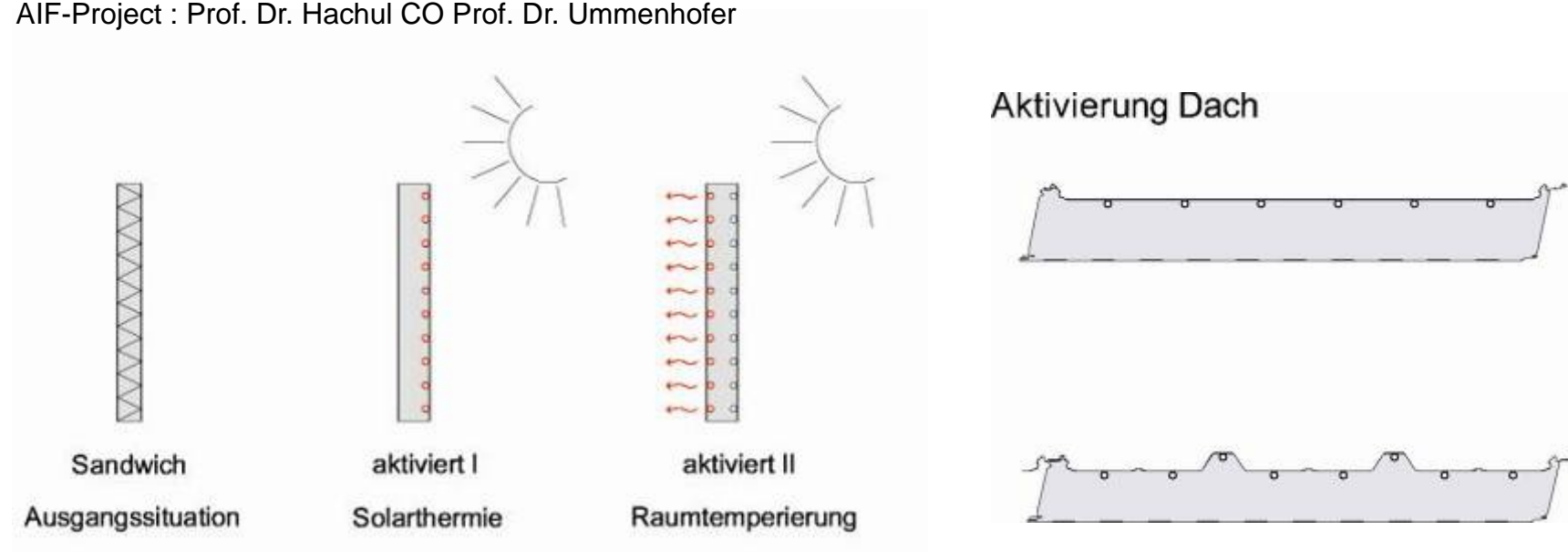

Monologue or dialogue

– the design of industrial building envelopes made of metal sheet



The design of industrial building envelopes made of metall sheet–

Make it better!

Monologue or dialogue

– the design of industrial building envelopes made of metal sheet

Many thanks for your attention!